



City of Dearborn Sustainable Lawns 50/50 Cost-share Program Application Form



This form is for applicants to the City of Dearborn Sustainable Lawns 50/50 Cost-share Program. Regardless of who designs and installs your project, you must complete this form to qualify your project for a reimbursement. If this application form is initially approved by the City, we will then send you the Participation Agreement Form for your signature and subsequent City signature.

Please complete this form for grant consideration and return as soon as possible while funding is still available. The City of Dearborn will then provide:

- 1. Project approval, OR**
- 2. Project approval dependent upon modifications, OR**
- 3. Project denial with explanation.**

Your Contact Information:

Name _____

Phone _____

Email _____

Project Address _____

Mailing Address _____

**For any
questions contact
Jeffrey Polkowski at:**

Email:

jpolkowski@ci.dearborn.mi.us

Phone: 313-943-2170

Fax: 313-943-2469

Mail Address:

Dearborn Administrative Center

16901 Michigan Avenue

Suite 14

Dearborn, MI 48126

Please provide all requested information on this application for the proposed rain garden that you are interested in completing and receiving a reimbursement for. Describe your idea to the best of your ability. If you have additional drawings and supplemental information you may attach those materials as well. You may submit drawings that you have designed yourself or you may hire a professional. Preliminary application drawings will NOT be reimbursed by this program.

Rain Garden

Landscape Designer _____

Installer _____

Pre-Rain Garden Land Cover Type (Lawn, Garden, Concrete, etc.) _____

Area of Rain Garden _____ sq. ft.

Area draining to project lawn or landscaping _____ sq. ft.

rooftop or other hard surface _____ sq. ft.

Rain garden sizing guidelines

Rain gardens should be large enough to store at least 1/2" of runoff from all contributing surfaces (roof, driveway, lawn, etc.). Typically, you can achieve this goal by sizing your garden at one-fifth the area of the contributing impervious surface area (roof, driveway, etc.). So, for example, if 750 square foot of roof area drains into the rain garden, your ballpark goal might be to design a 150 square foot rain garden with 3-6" of ponding depth (dig 5-8" deep, churn in 2" of compost, and top with 2" of shredded hardwood mulch). If your soils are mainly sand, you can halve the garden size. For heavy clay soils, double the size (300 square foot) and hold the ponding depth at 3" or less.

Results of the Percolation test _____

Will you be amending your soils? _____

Replacement soil mix components and percentage of soil mix makeup (e.g. 50/50 Sand and Compost Mix)

Rain Garden Cross Section - side view of your garden depicting ponding depth and berm height

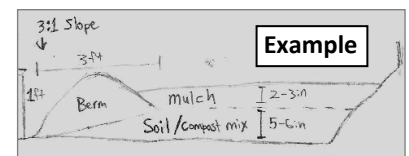

Directions as to how to conduct tests and build a rain garden can be found at <http://www.cityofdearborn.org/documents/city-departments/city-plan/sustainable-lawns-50-50-cost-share-program/4430-step-by-step-guide-to-building-a-rain-garden-sierra-club/file>

Site Sketch

Indicate where on the property the rain garden will be installed. The sketch should be of the property as viewed from above. Include north arrow, outline of buildings, driveways and sidewalks and show street names to provide perspective. Mark distances between the proposed rain garden and objects such as the home, garages, storage sheds, trees, existing landscaping, sidewalks, driveways, and roadways. You may attach an image Google Maps as a base. Attach your image and then mark on top of it with the above information.

Note: garden may not be installed in the right-of-way within one foot of the sidewalk or any easement.

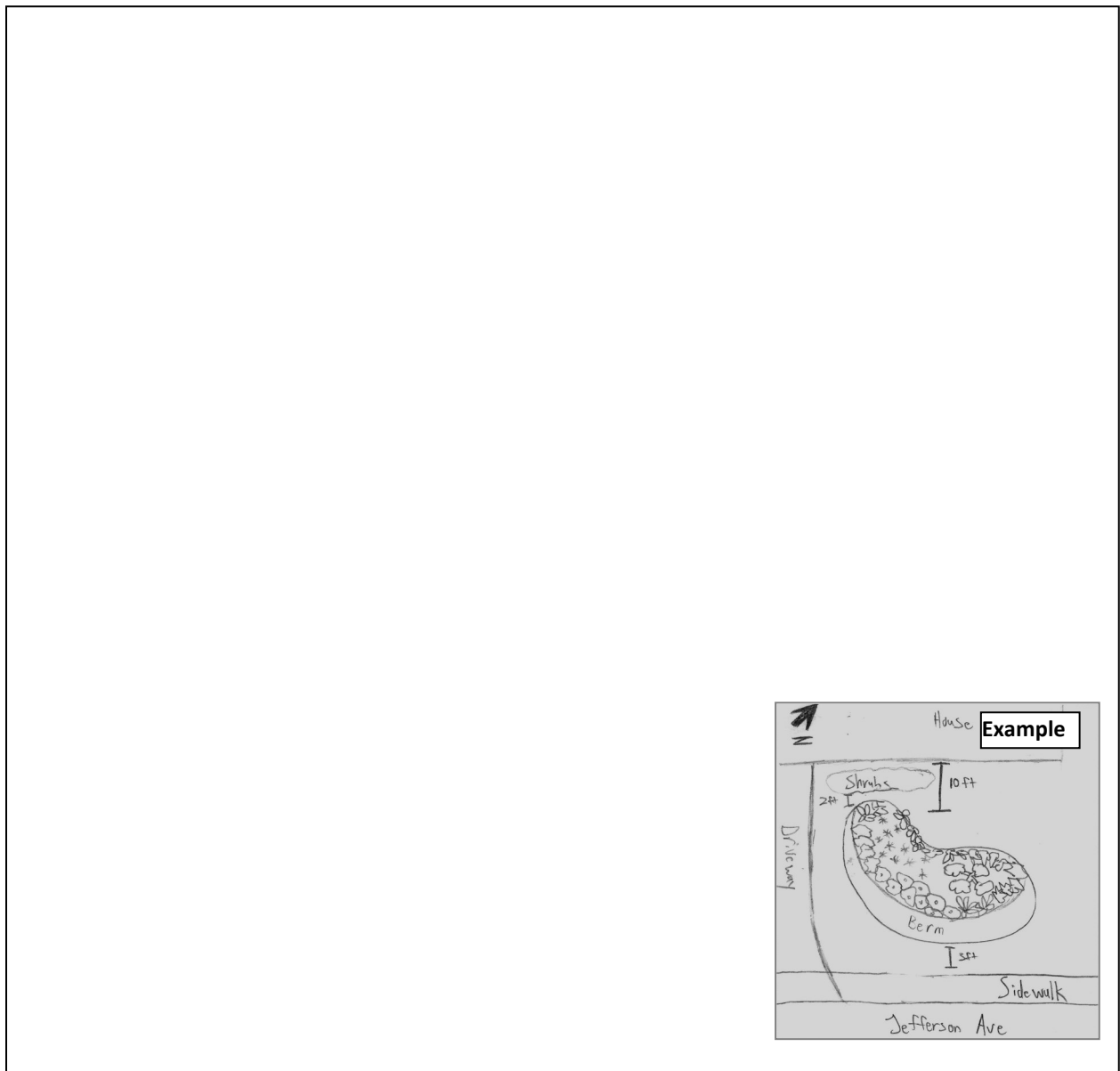

Plants, Materials and Services

To the best of your ability, itemize all of the plants and other materials that you plan to purchase for your project. You may attach a copy of an estimate provided by your landscape professional.

A native plant list is available at: http://www.ewashtenaw.org/government/drain_commissioner/

Plant List

Name	Size	Number	Price per plant*	Cost*	Source
			\$	\$	
			\$	\$	
			\$	\$	
			\$	\$	
			\$	\$	
			\$	\$	
			\$	\$	
			\$	\$	
			\$	\$	
			\$	\$	
			\$	\$	
			\$	\$	
			\$	\$	
			\$	\$	
			\$	\$	
			\$	\$	
			\$	\$	
			\$	\$	

Total Plant Cost: \$_____

Additional Materials and Services

Material	Description	Unit (bags, yards, pounds, etc.)	Price per unit*	Cost*
Mulch			\$	\$
Rain Garden Soil Mix			\$	\$
			\$	\$
			\$	\$
			\$	\$
			\$	\$
			\$	\$
			\$	\$

Total Additional Materials/Services Cost: \$_____

*Information needed only if completing project on your own. If you are working with a contractor, the cost estimate they provide can substitute for the itemized costs in the above tables.

Projected Total Cost of rain garden \$_____

Statement of Understanding

Complete and sign below **Statement of Understanding**. Unsigned forms will not be processed.

I _____, have completed this form accurately to the best of my ability. I understand that funds are limited and that if the funds for this calendar year have been depleted my application may not be accepted. I understand that I must contact Miss-Dig by calling before digging. To obtain a rebate after the project is completed, I must turn in all receipts within 4 months of the date the project is approved by the City of Dearborn. Upon receiving rebate, I will agree to maintain my project for 2 years.

Signature _____ Date _____

OFFICE USE ONLY

Application accepted for the following:

50% Cost Share Approvals:

- Rain Garden
- Hardscape removal
- Lawn Seeding
- Downspout Redirection

Application rejected; explanation below

Project Reviewed by: _____ Date: _____
