

Standard
US Postage
PAID
WSG

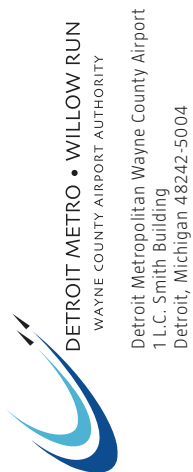

The Detroit Metropolitan Wayne County Airport (DTW) welcomed over 34 million passengers in 2016. The airport surpassed its 2015 total by more than 960,000 travelers. With service from 13 passenger airlines, DTW offers over 1,100 flights daily to four continents.

LEARN DETAILS ABOUT THE DTW MASTER PLAN UPDATE

Public Information Meeting

Thursday, March 2, 2017, 5-7:30 p.m.

*Wayne County Community College | Downriver Campus | Ray Mix Room
21000 Northline Road | Taylor, MI 48180*

detroitmetroairportmasterplan.org



DETROIT METRO • WILLOW RUN
WAYNE COUNTY AIRPORT AUTHORITY

DETROIT METROPOLITAN AIRPORT MASTER PLAN UPDATE



Final Public Information Meeting

Thursday, March 2, 2017, 5-7:30 p.m.

*Wayne County Community College | Downriver Campus | Ray Mix Room
21000 Northline Road | Taylor, MI 48180*

JOIN US!



The Detroit Metropolitan Airport Master Plan Update is a collaborative effort with local residents, airport users, local businesses and other stakeholders to effectively address the increasing needs of the airport's customers and surrounding communities.

THE DTW AIRPORT MASTER PLAN UPDATE

This Master Plan Update reviewed and evaluated improvements to the airport's primary facilities for the next 20 years. At the upcoming Final Public Information Meeting, Airport Authority staff will summarize the Plan's findings and recommendations.

For area residents and businesses, the Master Plan will lead to positive local economic impacts, including new jobs and increased local spending. For the traveling public, the Plan will enhance their overall travel experience with improved amenities and a focus on a greater customer experience.

The plan does not require the building of any new runways.

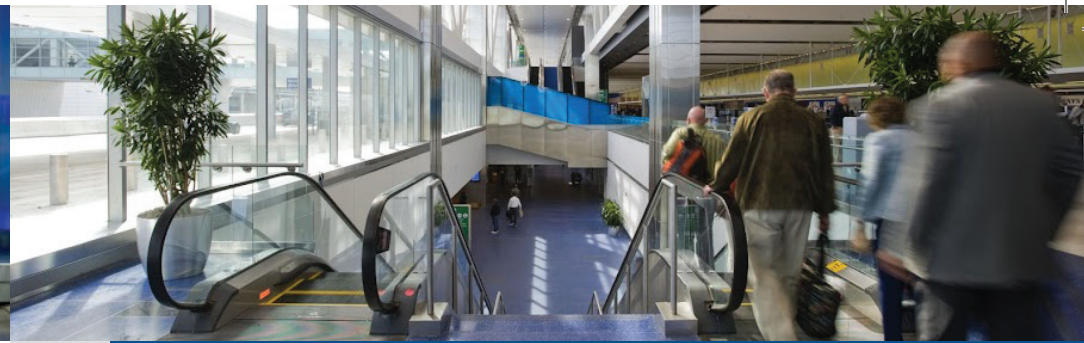

AIRPORT MASTER PLAN HIGHLIGHTS

Master Plan Update Improves and Enhances the Airport

The Master Plan identified improvements to enhance the airport campus that meet current design standards and improve safety as well as the customer experience.

The Plan is Affordable—No Costs for Residents and Businesses

One of the Airport Master Plan Update's primary objectives is to maintain competitive costs with other large hub airports in the U.S., while preparing for the growth forecasted in the number of airport travelers, which requires additional improvements for the airport. The costs of these improvements will be paid by airport users, not taxpayers.

The Plan Does Not Impact Residents and Surrounding Businesses

The master plan process found no need to construct new runways, new primary access roadways, new terminals, or expand the airport property boundary.

The recommended projects will not impact non-airport roadways or existing development patterns. They will not create adverse environmental impacts, such as increased aircraft noise exposure.

To learn more, please
JOIN US at the Final
Public Information Meeting.

