

~~* 4' FOR ASPHALT DRIVE PAVEMENT~~

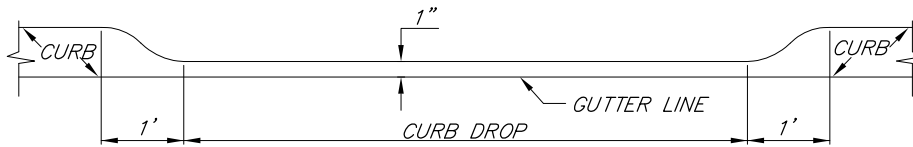

SECTION A-A

NOT TO SCALE

NOTES:

CONSTRUCT THE DRIVE APPROACH WITH 8" NON-REINFORCED CONCRETE ON 6" OF 21AA AGGREGATE BASE COURSE COMPACTED IN PLACE (CIP) ~~OR 6" HMA LEVELING ON 9" OF 21AA AGGREGATE BASE COURSE (CIP).~~

CURBS SHALL BE CONSTRUCTED WITH HEIGHT VARYING FROM 6" AT BACK OF CURB TO 0" HEIGHT AT FACE OF SIDEWALK OR RIGHT-OF-WAY LINE.

AT ALL CONCRETE DRIVES, PLACE A 1" EXPANSION JOINT AT BACK OF CURB AND 1/2" EXPANSION JOINT AT FACE OF SIDEWALK OR RIGHT-OF-WAY LINE. MAINTAIN NORMAL SIDEWALK GRADE ACROSS DRIVE, 2% SLOPE UP FROM FACE OF SIDEWALK.

INBOUND OR OUTBOUND RADIUS SHALL BE REDUCED TO 5' FOR ONE-WAY TRAFFIC DRIVE APPROACH.

DRIVE APPROACH SHALL NOT ENCROACH ACROSS PROPERTY LINE EXTENDED WITHOUT WRITTEN APPROVAL FROM THE ADJOINING PROPERTY OWNER.

WORK THIS SHEET WITH ~~THE GENERAL NOTES ON RS-1 AND D-6 SHEET 2-2.~~

REVISION DATE: 08/01/07

DIRECTOR OF ENGINEERING

DIVISION PERMIT ENGINEER

WAYNE COUNTY DEPARTMENT OF PUBLIC SERVICES
ENGINEERING DIVISION/PERMIT OFFICE
PERMIT STANDARDS

COMMERCIAL DRIVE APPROACH

SCALE
NOT TO SCALE

D-6

SHEET
1 OF 2

CURB RETURN JOINING EXISTING PAVEMENT

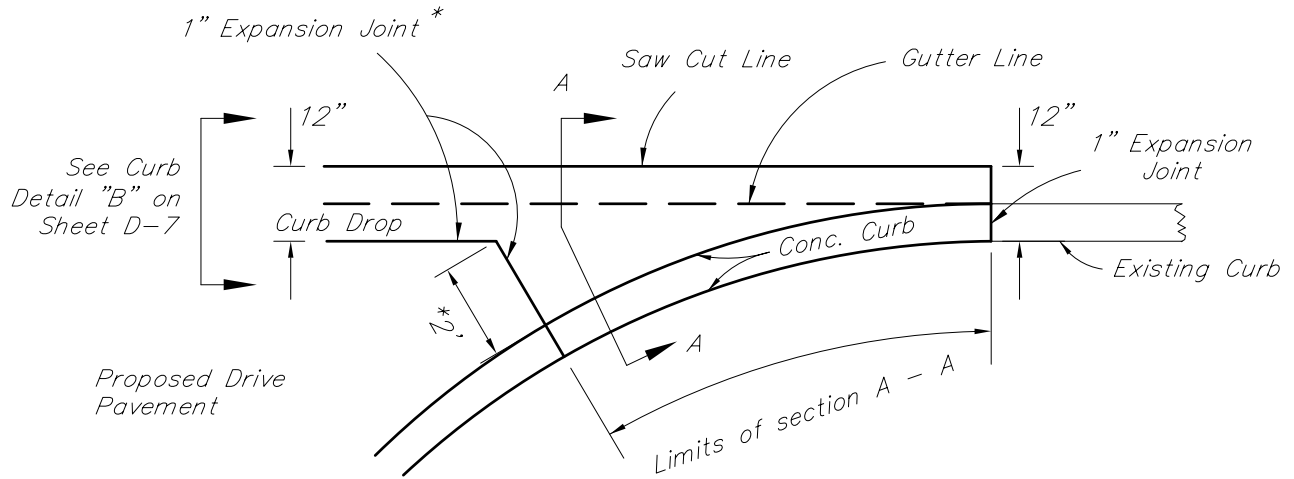

~~* 1' for HMA Drive Pavement. No Expansion Joint Required.~~

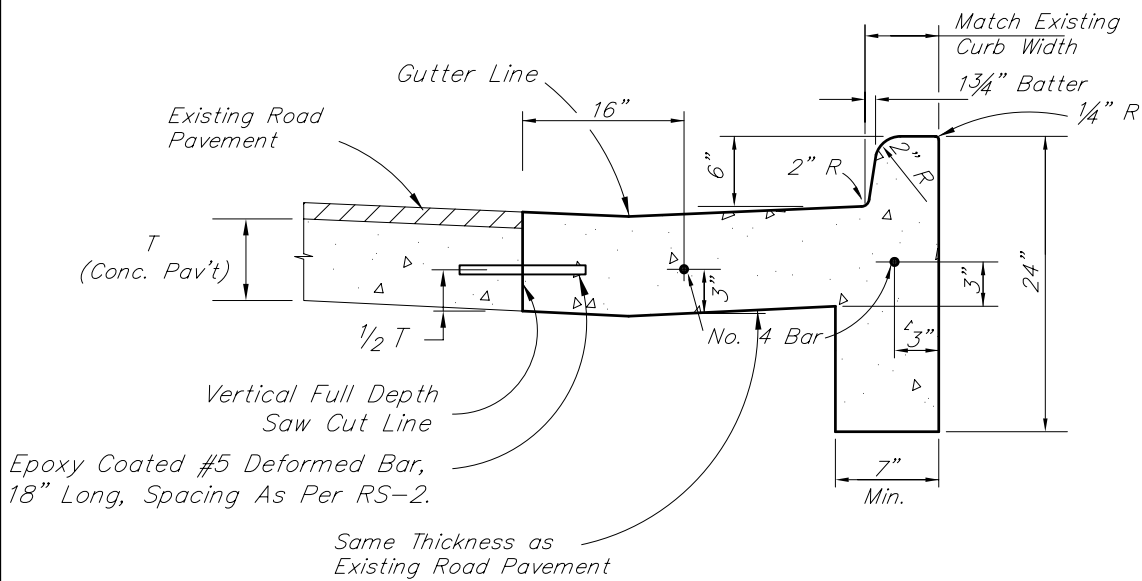

Section "A - A"

~~WORK THIS SHEET WITH THE GENERAL NOTES ON RS 1.~~

REVISION DATE: 08/01/07
DIRECTOR OF ENGINEERING
DIVISION PERMIT ENGINEER

WAYNE COUNTY DEPARTMENT OF PUBLIC SERVICES
 ENGINEERING DIVISION/PERMIT OFFICE
 PERMIT STANDARDS
COMMERCIAL DRIVE APPROACH

SCALE NOT TO SCALE
D-6
SHEET 2 OF 2

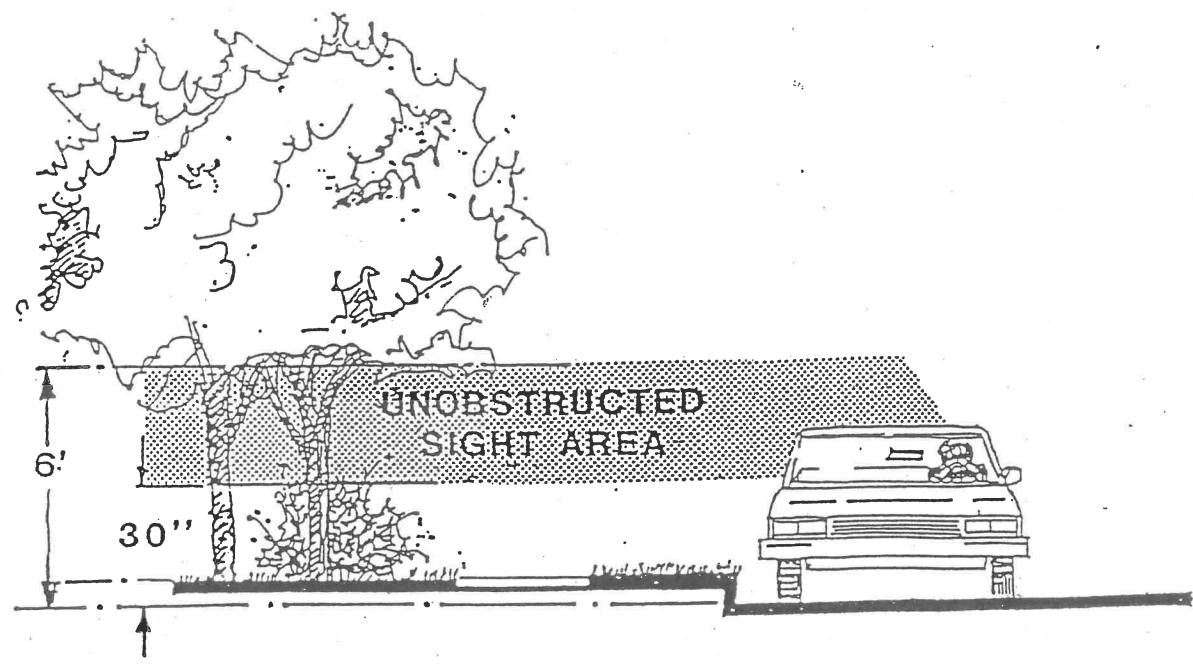
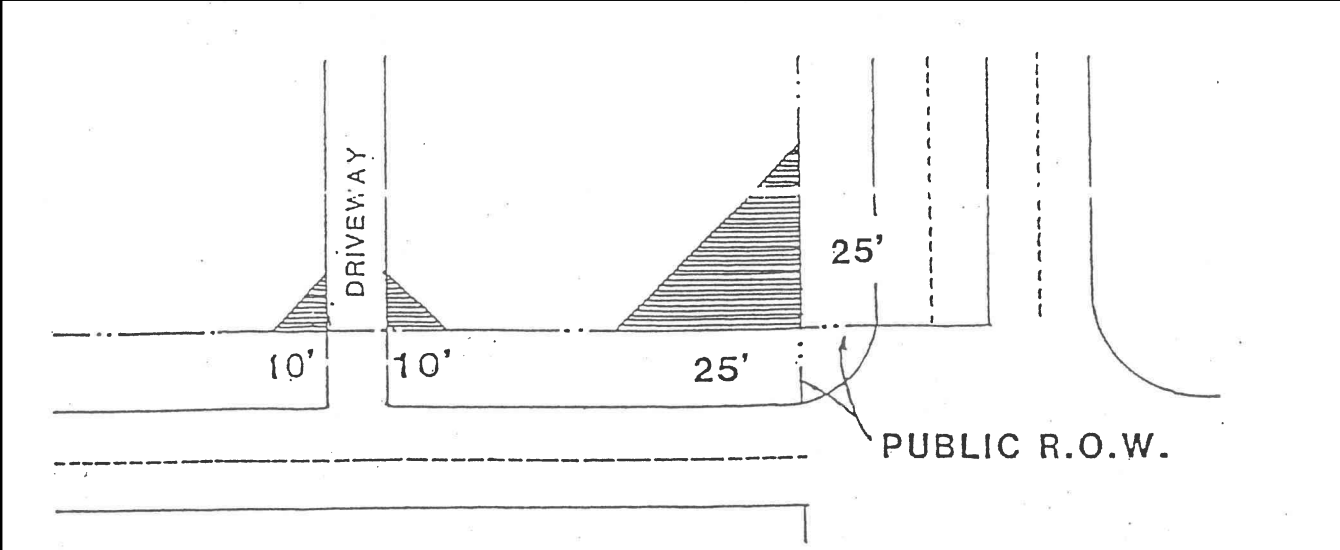
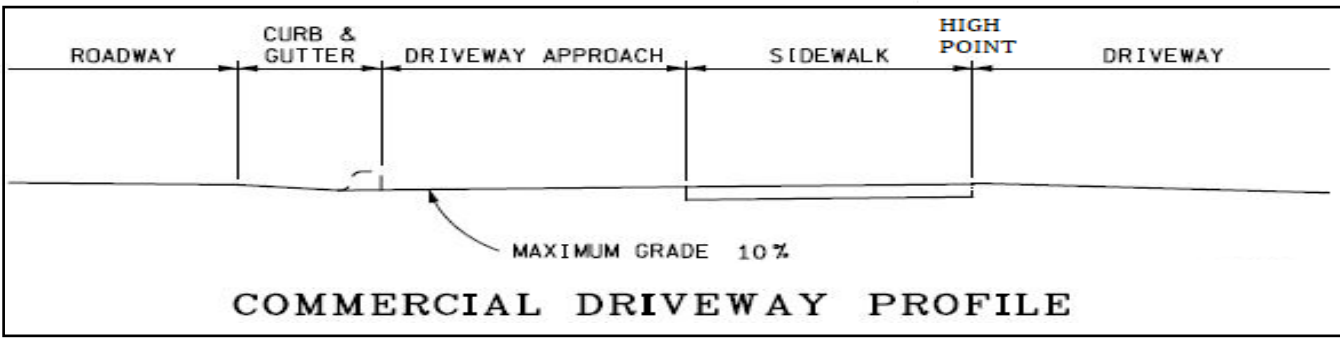

UNOBSTRUCTED SIGHT DISTANCE

Section 2.09, sub-section A.4